

Issued - 31 October 2019

 Tel - +44 (0) 1761 241133
 Fax - +44 (0) 1761 241134
www.bathroom-engineering.co.uk

TECEpuretile™

A high specification stainless steel shower drain designed for all floor types, including UK style 'WOOD over JOIST' & also concrete floors. Features include stainless steel chassis, UK compliant trap (50mm water seal), & grate to suit tiles & porcelain. A simple, flexible & easy to install shower drain, that suits all shower installations. E&OE



PRODUCT CHARACTERISTICS

- Suits refurbishment & new build projects, universal shower drain for all common floor substrates, incl. wood over joist, concrete screed etc.
- Very high quality polished 304 grade stainless steel chassis, suitable for common cleaners (when applied according to instructions)
- Central outlet position, accommodates different trap options, that rotate to connect the trap to soil pipes in any direction.
- Standard horizontal trap has a UK compliant 50mm water seal, that suits optional secondary foul air trap (with a physical vapour barrier).
- Optional traps offer vertical outlets, lower build in heights, or ultra high flow rates. All trap options are rotatable through 360°.
- Supplied as standard with UK style DN50 > 2" adaptor.
- Chassis incl. stainless steel installation flange to support the chassis in common U.K. style timber floors.
- Suits matching 'Seal System' waterproof sealing membrane.
- Vertical upstand on chassis suits all finishes, and the matching grate means height adjustment is not required.
- Standard 'Seal System' self-adhesive waterproof tanking tape is supplied, and is compatible with all common liquid style membranes.
- Optional 'FireStop Protection Set' for Concrete Slab floors, suits vertical traps & provides protection against fire ingress between floors

APPLICATIONS

TECEpuretile™ shower channels are wide collection vessels used within wet room showers, & are offered in various lengths. Suits:

- En-Suites – small bathrooms where space efficiency is at a premium
- High End Designer Bathrooms – Large sizes add to the feeling of space within a shower area
- Refurbishments & New Build
- Floor Substrates – Designed for concrete floors & screeds, as well as UK wooden floor boards

MATERIAL

- | | |
|-----------------|---|
| • Drain Chassis | : Chassis - 0.75 ^m / _m 304 Stainless Steel |
| • Grate | : Grate - 0.85 ^m / _m 304 Stainless Steel, for tiles, thin stone & porcelain |
| • Trap | : PP Trap (Matching U.K. Adaptor Supplied : ABS) |

TECHNICAL DATA

- | | |
|---------------------------------|---|
| • Size Channel, Standard, Stock | : 700, 800, 900, 1000, 1200, 1500 ^m / _m |
| • Size Channel, 'Made to Order' | : Information available on request (N.B. Min. production volumes & Max. sizes apply – Call for Info) |
| • Visible Size | : Width = 71 ^m / _m : Length = Nominal, less 49 ^m / _m (e.g. 800 ^m / _m drain is visible grate of 751 ^m / _m x 71 ^m / _m) |
| • Cross Section Profile | : Chassis Channel : 27 ^m / _m overall (13 ^m / _m sub-flange cross section, & 14 ^m / _m vertical upstand) |
| • Waste & Trap | : Outlet DIN 50: Trap has UK compliant 50 ^m / _m Water Seal (options incl. 30mm & 35mm). See options |
| • Suitable Floor Covering | : Natural Stone or Tile, to all standard finishes, to a max. of 14 ^m / _m build-up, incl. adhesive |
| • Installation Sealing Kit | : INCLUDED - 'Seal System' self-adhesive waterproof tanking tape fitted on site to surrounding flange |
| | : Optional – Matching AquaeGUARD Waterproof Membranes ~ See Data Sheets |
| • Gradient | : A floor gradient of max. 1% > 1.5% must be built into the surrounding floors |

CAPACITY

- Waste & Trap - Standard : 50^m/_m Water Seal, Horizontal Outlet (38 > 48 Ltrs/Min) location dependant

TRAP OPTIONAL EXTRAS

- | | |
|----------------|--|
| • Waste & Trap | : Horizontal (31 > 37 Ltrs/Min) location dependant |
| • Waste & Trap | : Horizontal (28 > 33 Ltrs/Min) location dependant |



Issued - 31 October 2019

- Waste & Trap : Vertical (28 > 33 Ltrs/Min)

INSTALLATION INSTRUCTIONS

- See Separate Sheet : Included in Package

PACKAGING

- Cardboard / Sleeve : Made to suit Shower Channel

CONTENTS (complete shower channel drain) comprising :

- Stainless steel, chassis with centre outlet, supplied c/w waterproofing membrane for fitting on site
- Foul air trap – Rotatable, push fit, with horizontal DN 50^m outlet, DN50 > 2" adaptor
- Stainless steel grate, for tiles, stone, & porcelain to 14^m/m build-up, incl. adhesive.
- Height adjustable legs (for concrete floors)
- Installation Instructions

SPECIFICATION – TECEpuretile™ linear shower channel drain in 304 Stainless Steel with supporting installation flange, waterproofing membrane, high flow, rotatable (360°) trap & matching removable grate for tile to 14^m/m. build-up, incl. adhesive

Range	Size	ART No.
TECEpuretile™	700 ^m Shower Drain Chassis, & Trap c/w Grate, for Tiles. Incl. Seal System	WD 008 01067
TECEpuretile™	800 ^m Shower Drain Chassis, & Trap c/w Grate, for Tiles. Incl. Seal System	WD 008 01068
TECEpuretile™	900 ^m Shower Drain Chassis, & Trap c/w Grate, for Tiles. Incl. Seal System	WD 008 01069
TECEpuretile™	1000 ^m Shower Drain Chassis, & Trap c/w Grate, for Tiles. Incl. Seal System	WD 008 01070
TECEpuretile™	1200 ^m Shower Drain Chassis, & Trap c/w Grate, for Tiles. Incl. Seal System	WD 008 01072
TECEpuretile™	1500 ^m Shower Drain Chassis, & Trap c/w Grate, for Tiles. Incl. Seal System	WD 008 01075

Dimensional Guide

Size :
Flange Space Required :
L + 11^m/m
Visible Void & Grate : L – 60^m/m
e.g. : 800 Drain Chassis is
Below Finish : 811^m/m x 151^m/m
Visible Grate : 751^m/m x 71^m/m

Build-In Height with Standard Trap
to :
Finished Floor Level : 120^m/m
Un-finished Floor/Flange : 107^m/m

E&OE – We reserve the right to alter
& amend specifications without prior
notice. This is not a specification
document & does not guarantee
performance
© Bathroom Engineering™
October 2019

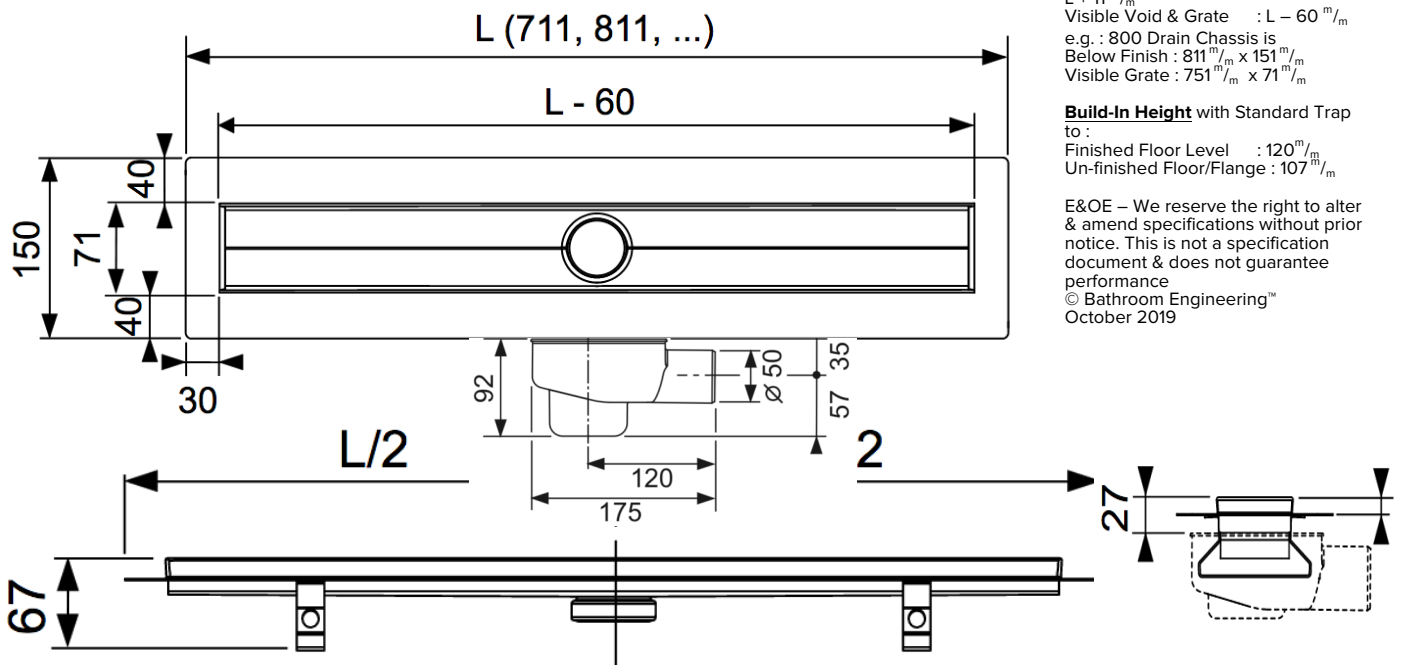

TECE